

A30 Chiverton to Carland Cross TR010026

2.4 WORKS PLANS

Planning Act 2008

APFP Regulation 5(2)(j)
Infrastructure Planning (Applications: Prescribed
Forms and Procedure) Regulations 2009

Volume 2

August 2018

Infrastructure Planning

Planning Act 2008

**The Infrastructure Planning
(Applications: Prescribed Forms and
Procedure) Regulations 2009**

**A30 Chiverton to Carland Cross
Development Consent Order 201[x]**

2.4 WORKS PLANS

Regulation Number:	APFP Regulation 5(2)(j)
Planning Inspectorate Scheme Reference	TR010026
Application Document Reference	2.4
Author:	A30 Chiverton to Carland Cross Project Team, Highways England

Version	Date	Status of Version
C01	August 2018	Application Issue

Contents

1. WORKS PLANS - KEY PLAN
2. WORKS PLANS - SHEET 1 OF 8
3. WORKS PLANS - SHEET 2 OF 8
4. WORKS PLANS - SHEET 3 OF 8
5. WORKS PLANS - SHEET 4 OF 8
6. WORKS PLANS - SHEET 5 OF 8
7. WORKS PLANS - SHEET 6 OF 8
8. WORKS PLANS - SHEET 7 OF 8
9. WORKS PLANS - SHEET 8 OF 8

DO NOT SCALE

0 10 100
Millimetres

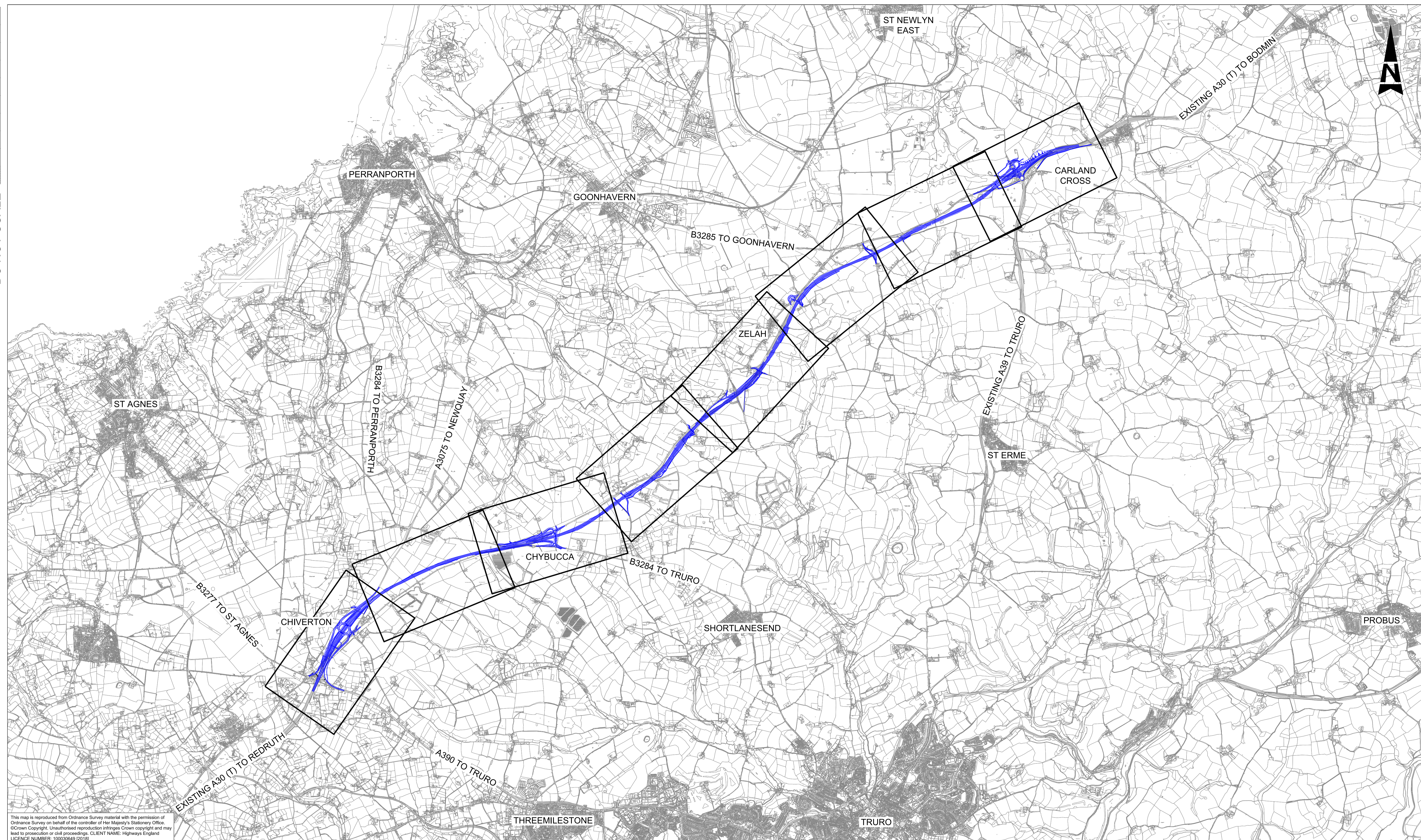

This map is reproduced from Ordnance Survey material with the permission of Ordnance Survey on behalf of the controller of Her Majesty's Stationery Office. © Crown Copyright. Unauthorised reproduction infringes Crown copyright and may lead to prosecution or civil proceedings. CLIENT NAME: Highways England LICENCE NUMBER: 100030649 (2018)

GENERAL NOTES:
1. ALL DIMENSIONS ARE IN METRES UNLESS NOTED OTHERWISE.
2. ONLY WRITTEN DIMENSIONS SHALL BE USED, DO NOT SCALE.
LEGEND:
 THE SCHEME (SHOWN FOR ILLUSTRATIVE PURPOSES)

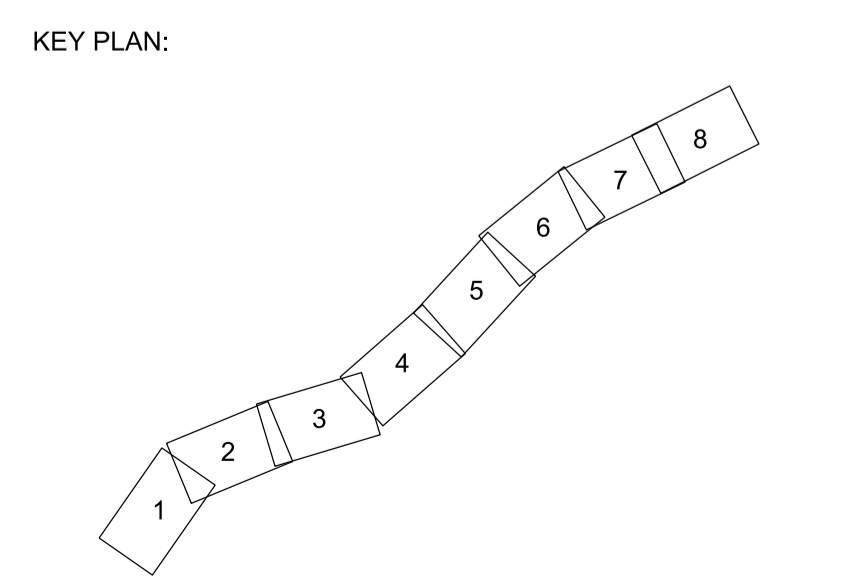
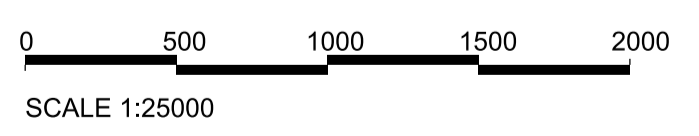

Rev.	Date	Description	By	Chk'd	App'd	Auth'd
—	—	—	—	—	—	—
—	—	—	—	—	—	—
—	—	—	—	—	—	—
—	—	—	—	—	—	—
—	—	—	—	—	—	—
P01	04/07/18	P01	ES	RC	RC	—
P02	04/07/18	ISSUED FOR COMMENT	ES	RC	RC	RC
P03	22/08/18	DCO ISSUE	AJ	LP	RC	RC
P04	22/08/18	DCO ISSUE	AJ	LP	RC	SW
C01	22/08/18	DCO ISSUE	AJ	LP	RC	SW

Suitability: A3
Drawing Status: STAGE COMPLETED



Project Title A30 CHIVERTON TO CARLAND CROSS					
Drawing Title WORKS PLANS APFP REGULATION 5(2)(J) KEY PLAN					
Scale 1:25000	By AJ	Checked LP	Approved RC	Authorised SW	
Original Size A1	Date 22/08/18	Date 22/08/18	Date 22/08/18	Date 22/08/18	Date 22/08/18
Drawing Number HE PIN HA551502 - SW	Originator ARP	Volume LSI	-DR - ZL -000400		Revision C01
Location	Type	Role	Number		

DO NOT SCALE

100
Millimetres

0 10

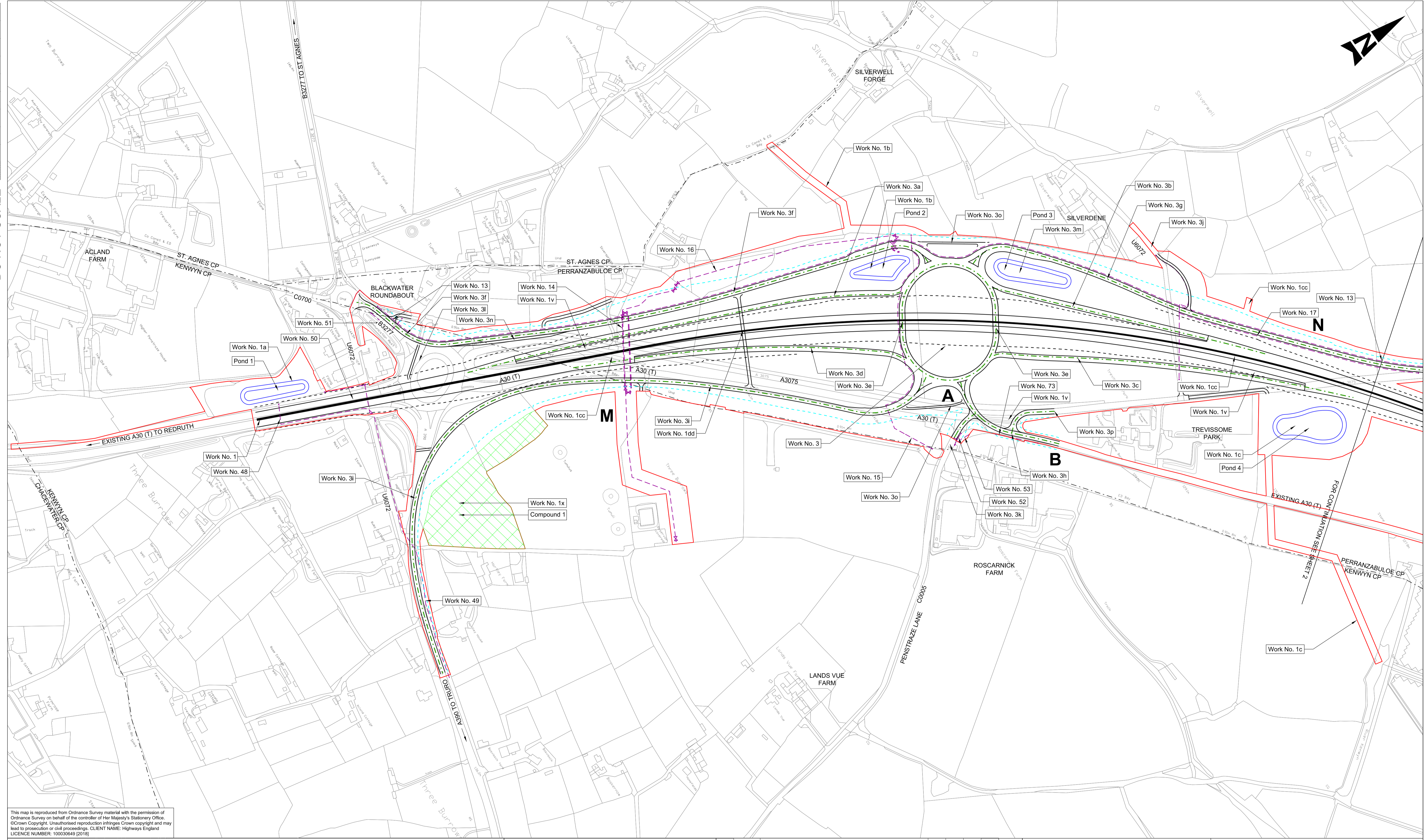
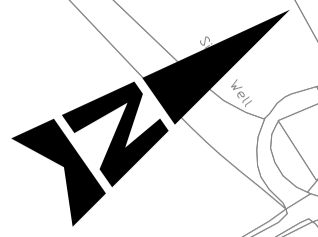

This map is reproduced from Ordnance Survey material with the permission of Ordnance Survey on behalf of the controller of Her Majesty's Stationery Office. © Crown Copyright. Unauthorised reproduction infringes Crown copyright and may lead to prosecution or civil proceedings. CLIENT NAME: Highways England LICENCE NUMBER: 100030649 (2018)

- GENERAL NOTES:**
1. ALL DIMENSIONS ARE IN METRES UNLESS NOTED OTHERWISE.
 2. ONLY WRITTEN DIMENSIONS SHALL BE USED, DO NOT SCALE.
 3. THESE PLANS SHOULD BE READ IN CONJUNCTION WITH OTHER PLANS AND APPLICATION DOCUMENTS IN PARTICULAR SCHEDULE 3 OF THE DEVELOPMENT CONSENT ORDER.
- LEGEND:**
- DEVELOPMENT CONSENT ORDER BOUNDARY
 - A30 MAINLINE CENTRELINE
 - EXTENT OF CARRIAGEWAY (INCLUDING 0.5M LATERAL DEVIATION)
 - - - A30 MAINLINE EARTHWORKS (INCLUDING 1.75M LATERAL DEVIATION)
 - - - SIDE ROAD, JUNCTION AND SLIP ROAD CENTRELINE
 - - - SIDE ROAD EARTHWORKS (INCLUDING 1.75M LATERAL DEVIATION)
 - UTILITY DIVERSION WORK CENTRELINE
 - ATTENUATION POND BOUNDARY
 - - - PARISH BOUNDARY

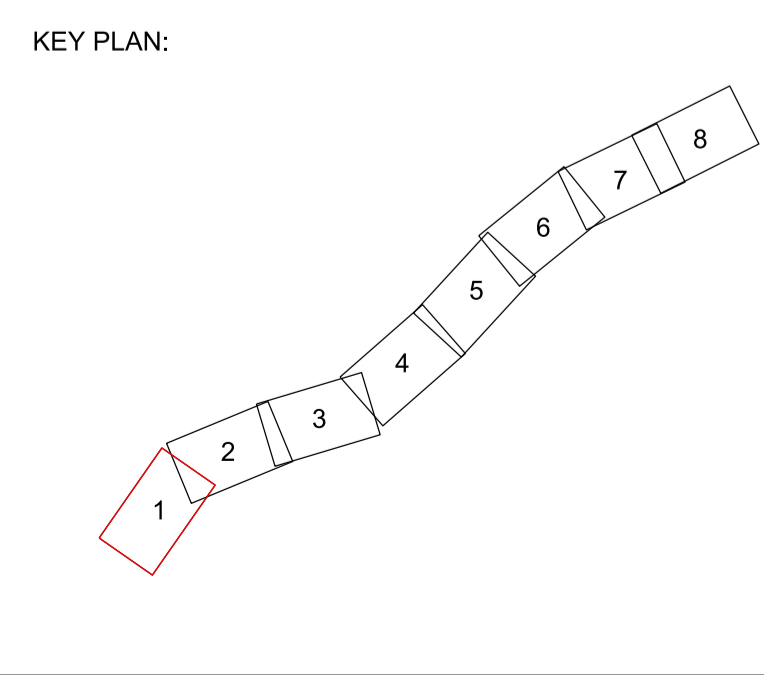
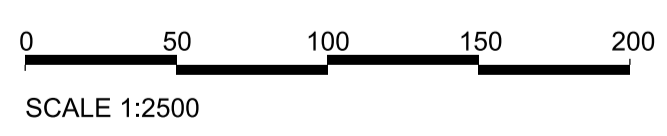

Rev.	Date	Description	By	Chk'd	App'd	Auth'd
P06	04/07/18	ISSUED FOR COMMENT	RC	RC	RC	RC
P07	06/07/18	ISSUED FOR COMMENT	ES	LP	RC	RC
P08	06/07/18	ISSUED FOR COMMENT	ES	LP	RC	RC
P09	02/08/18	FOR SIGN OFF	HJ	SW	DG	—
P10	02/08/18	FOR SIGN OFF	HJ	SW	DG	SW
P11	20/08/18	P11	HJ	LP	RC	—
P12	21/08/18	DCO ISSUE	HJ	LP	RC	—
P13	21/08/18	DCO ISSUE	HJ	LP	RC	RC
P14	22/08/18	DCO ISSUE	HJ	LP	RC	SW
C01	22/08/18	DCO ISSUE	HJ	LP	RC	SW

Suitability: **A3** | Drawing Status: **STAGE COMPLETED**

Client:

Project Title: A30 CHIVERTON TO CARLAND CROSS					
Drawing Title: WORKS PLANS APFP REGULATION 5(2)(J) SHEET 1 OF 8					
Scale: 1:2500	By: HJ	Checked: LP	Approved: RC	Authorised: SW	
Original Size: A1	Date: 21/08/18	Date: 21/08/18	Date: 21/08/18	Date: 22/08/18	Date: 22/08/18
Drawing Number: HA551502 - SW	Originator: ARP	Volume: LSI	-DR - ZL - 000401		Revision: C01
Location:	Type:	Role:	Number:		

DO NOT SCALE

100
0 10
Millimetres

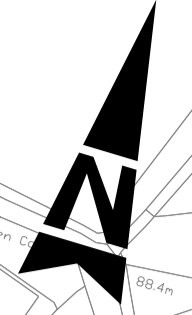
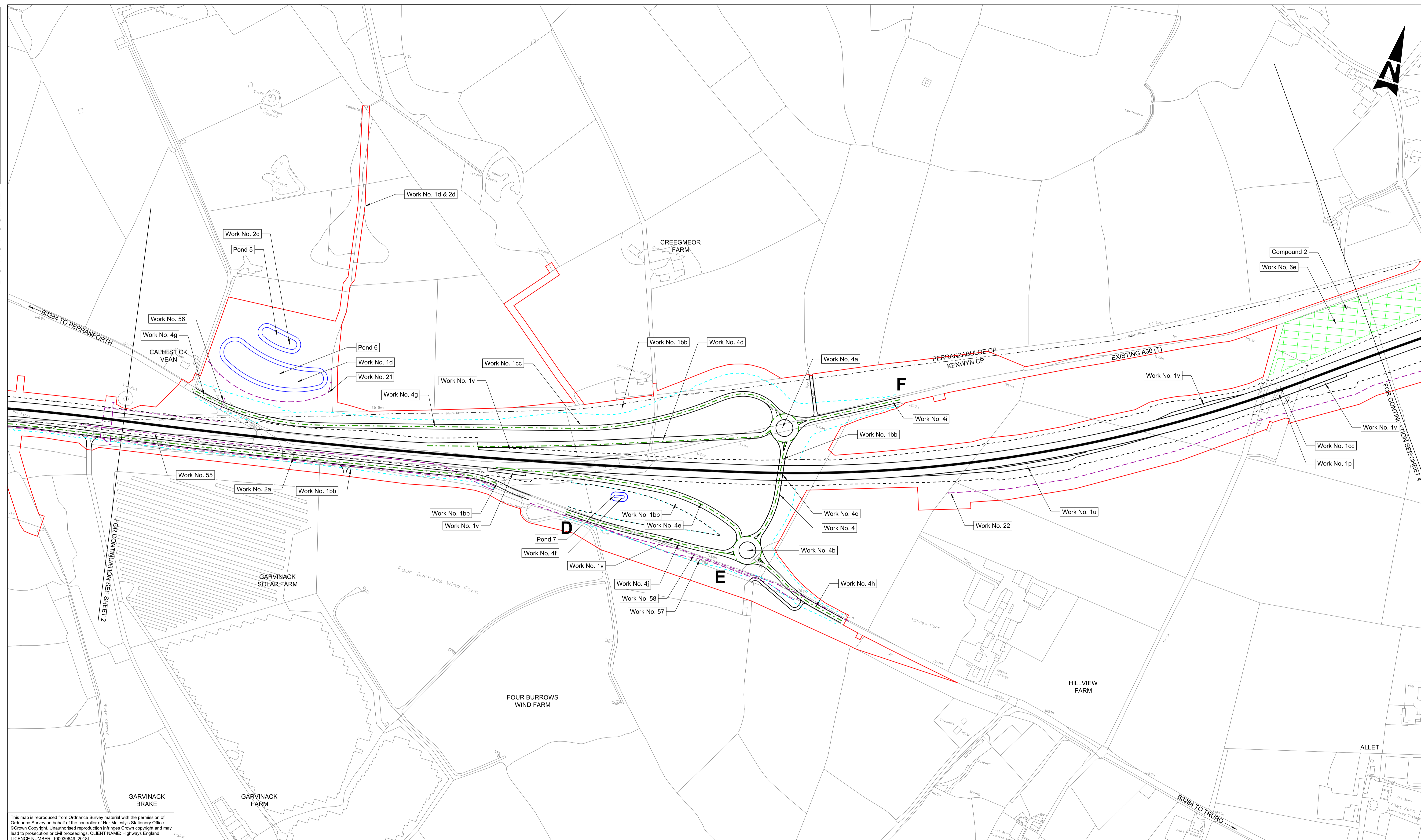

This map is reproduced from Ordnance Survey material with the permission of Ordnance Survey on behalf of the controller of Her Majesty's Stationery Office. © Crown Copyright. Unauthorised reproduction infringes Crown copyright and may lead to prosecution or civil proceedings. CLIENT NAME: Highways England LICENCE NUMBER: 100030649 (2018)

GENERAL NOTES:
 1. ALL DIMENSIONS ARE IN METRES UNLESS NOTED OTHERWISE.
 2. ONLY WRITTEN DIMENSIONS SHALL BE USED, DO NOT SCALE.
 3. THESE PLANS SHOULD BE READ IN CONJUNCTION WITH OTHER PLANS AND APPLICATION DOCUMENTS IN PARTICULAR SCHEDULE 3 OF THE DEVELOPMENT CONSENT ORDER.

- LEGEND:
- DEVELOPMENT CONSENT ORDER BOUNDARY
 - A30 MAINLINE CENTRELINE
 - EXTENT OF CARRIAGEWAY (INCLUDING 0.5M LATERAL DEVIATION)
 - - - A30 MAINLINE EARTHWORKS (INCLUDING 1.75M LATERAL DEVIATION)
 - - - SIDE ROAD, JUNCTION AND SLIP ROAD CENTRELINE
 - - - SIDE ROAD EARTHWORKS (INCLUDING 1.75M LATERAL DEVIATION)
 - - - UTILITY DIVERSION WORK CENTRELINE
 - - - ATTENUATION POND BOUNDARY
 - - - PARISH BOUNDARY

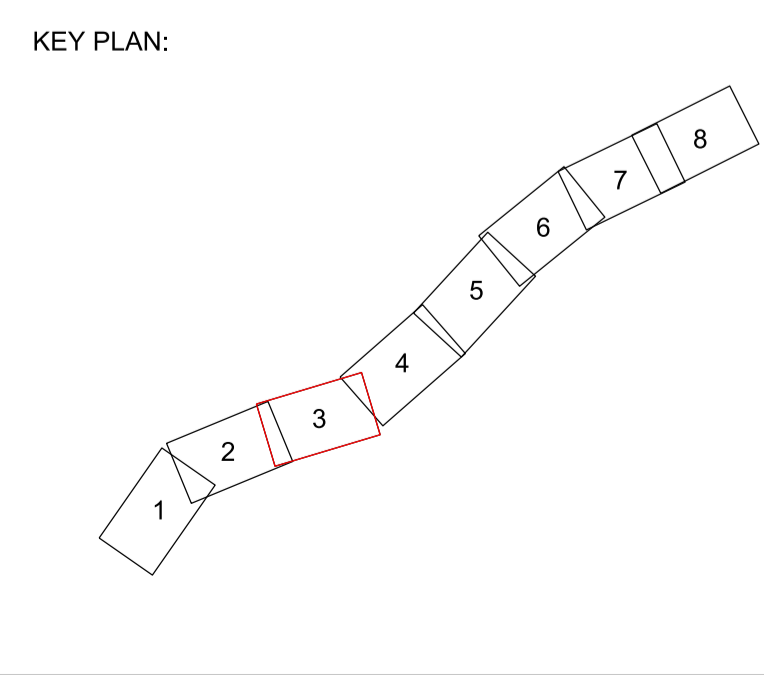
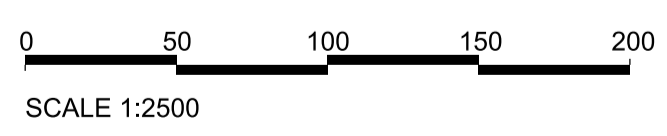

Rev.	Date	Description	By	Chk'd	App'd	Auth'd
P04	20/08/18	ISSUED FOR COMMENT	LP	LP	RC	RC
P05	04/07/18	ISSUED FOR COMMENT	ES	RC	RC	—
P06	04/07/18	ISSUED FOR COMMENT	ES	RC	RC	RC
P07	02/08/18	FOR SIGN OFF	HJ	SW	DG	—
P08	02/08/18	FOR SIGN OFF	HJ	SW	DG	SW
P09	20/08/18	P09	HJ	LP	RC	—
P10	21/08/18	DCO ISSUE	HJ	LP	RC	—
P11	21/08/18	DCO ISSUE	HJ	LP	RC	RC
P12	22/08/18	DCO ISSUE	HJ	LP	RC	SW
C01	22/08/18	DCO ISSUE	HJ	LP	RC	SW

Suitability: **A3** Drawing Status: **STAGE COMPLETED**

Client:

Project Title: **A30 CHIVERTON TO CARLAND CROSS**

Drawing Title: **WORKS PLANS APFP REGULATION 5(2)(J) SHEET 3 OF 8**

Scale	By	Checked	Approved	Authorised
1:2500	HJ	LP	RC	SW

Original Size	Date	Date	Date	Date
A1	21/08/18	21/08/18	21/08/18	22/08/18

Drawing Number	HE PIN	Originator	Volume	Revision
HA551502 - SW	ARP	LSI	-DR - ZL - 000403	C01

DO NOT SCALE

Millimetres

0 10

100

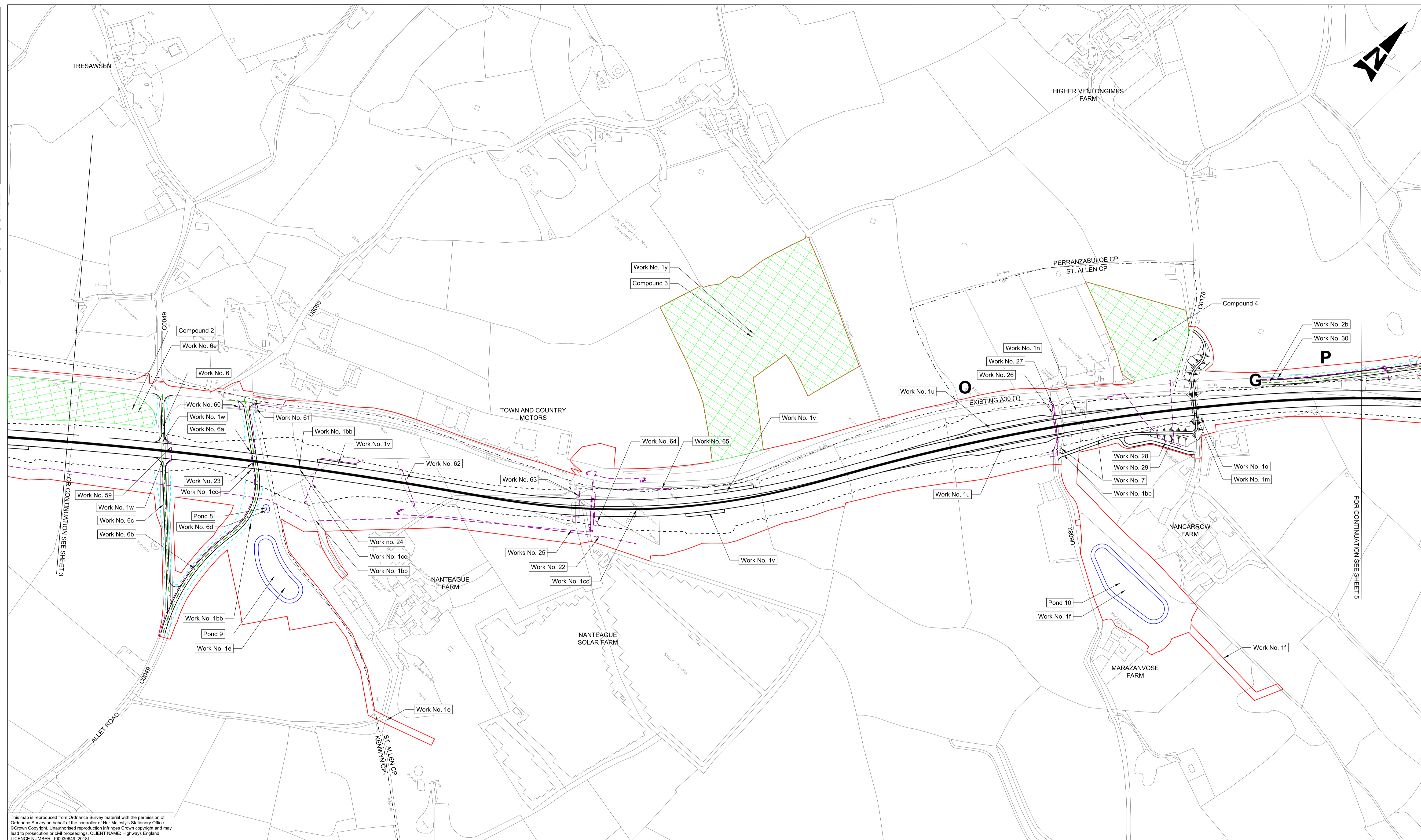

This map is reproduced from Ordnance Survey material with the permission of Ordnance Survey on behalf of the controller of Her Majesty's Stationery Office. © Crown Copyright. Unauthorised reproduction infringes Crown copyright and may lead to prosecution or civil proceedings. CLIENT NAME: Highways England LICENCE NUMBER: 100030649 (2018)

- GENERAL NOTES:
- ALL DIMENSIONS ARE IN METRES UNLESS NOTED OTHERWISE.
 - ONLY WRITTEN DIMENSIONS SHALL BE USED, DO NOT SCALE.
 - THESE PLANS SHOULD BE READ IN CONJUNCTION WITH OTHER PLANS AND APPLICATION DOCUMENTS IN PARTICULAR SCHEDULE 3 OF THE DEVELOPMENT CONSENT ORDER.
- LEGEND:
- DEVELOPMENT CONSENT ORDER BOUNDARY
 - A30 MAINLINE CENTRELINE
 - EXTENT OF CARRIAGEWAY (INCLUDING 0.5M LATERAL DEVIATION)
 - A30 MAINLINE EARTHWORKS (INCLUDING 1.75M LATERAL DEVIATION)
 - SIDE ROAD, JUNCTION AND SLIP ROAD CENTRELINE
 - SIDE ROAD EARTHWORKS (INCLUDING 1.75M LATERAL DEVIATION)
 - UTILITY DIVERSION WORK CENTRELINE
 - ATTENUATION POND BOUNDARY
 - PARISH BOUNDARY

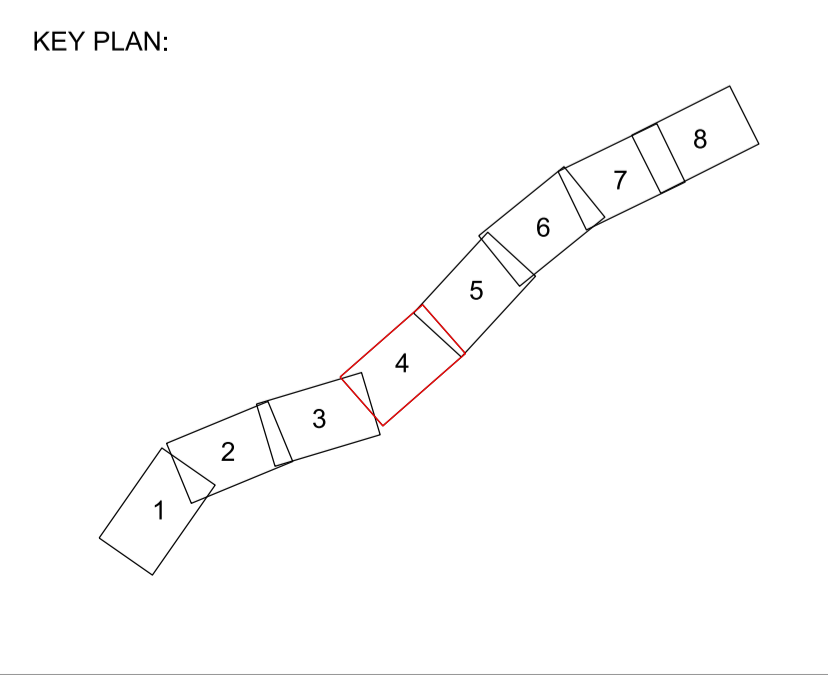
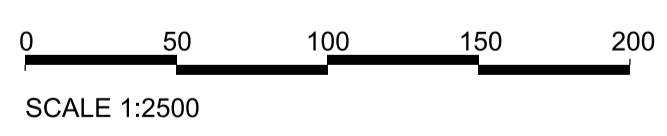

Rev.	Date	Description	By	Chk'd	App'd	Auth'd
P04	20/06/18	ISSUED FOR COMMENT	LP	LP	RC	RC
P05	04/07/18	ISSUED FOR COMMENT	ES	RC	RC	RC
P06	04/07/18	ISSUED FOR COMMENT	ES	RC	RC	RC
P07	02/08/18	FOR SIGN OFF	HJ	SW	DG	—
P08	02/08/18	FOR SIGN OFF	HJ	SW	DG	SW
P09	20/08/18	P09	HJ	LP	RC	—
P10	21/08/18	DCO ISSUE	HJ	LP	RC	—
P11	21/08/18	DCO ISSUE	HJ	LP	RC	RC
P12	22/08/18	DCO ISSUE	HJ	LP	RC	SW
C01	22/08/18	DCO ISSUE	HJ	LP	RC	SW

Suitability: A3
 Drawing Status: STAGE COMPLETED

Client:

Project Title: A30 CHIVERTON TO CARLAND CROSS

Drawing Title: WORKS PLANS APFP REGULATION 5(2)(J) SHEET 4 OF 8

Scale	By	Checked	Approved	Authorised
1:2500	HJ	LP	RC	SW

Original Size	Date	Date	Date	Date
A1	21/08/18	21/08/18	21/08/18	22/08/18

Drawing Number: HA551502 - SW
 HE PIN: ARP
 Originator: LSI
 Volume: -DR-ZL-000404
 Revision: C01

DO NOT SCALE

Millimetres

0 10

100

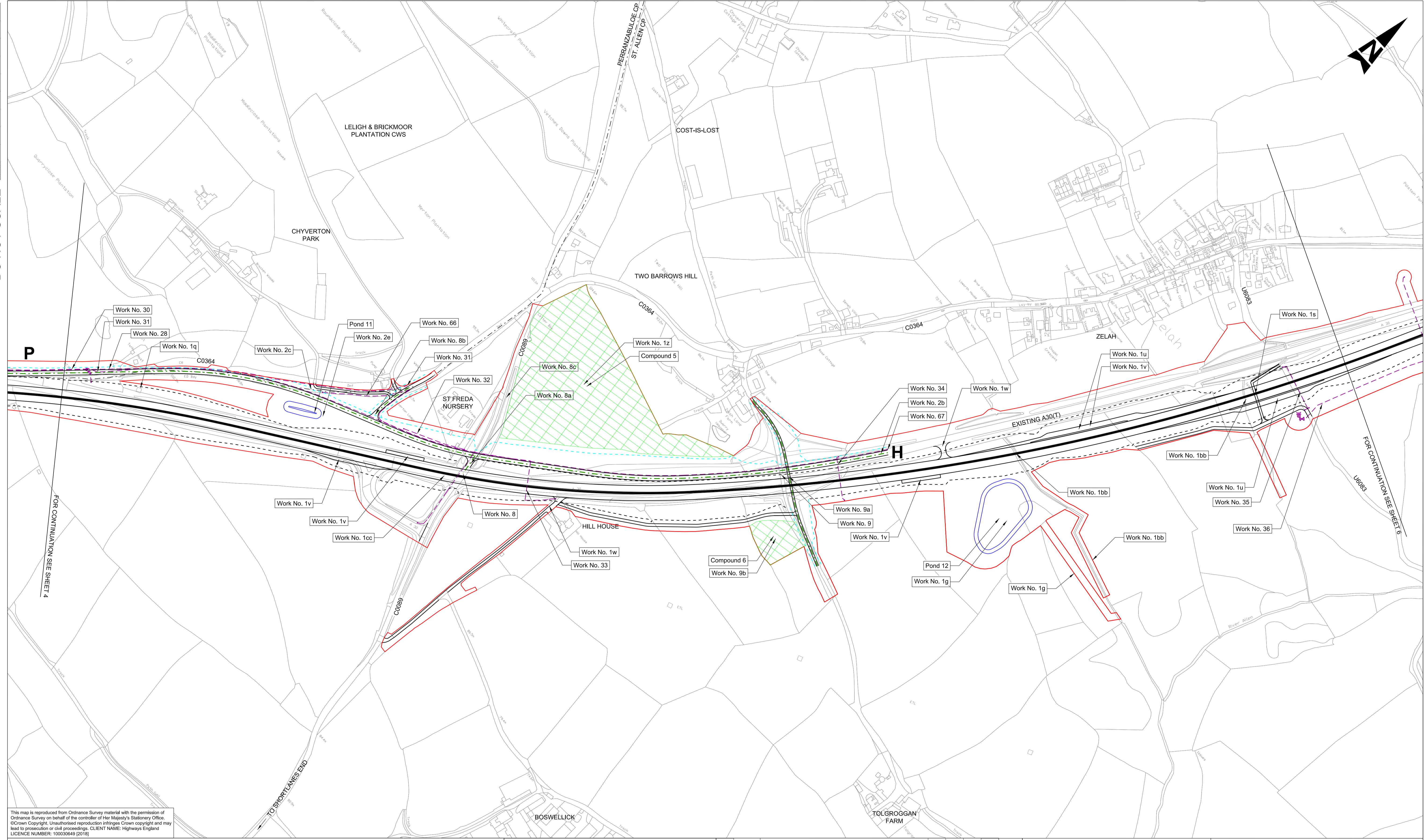
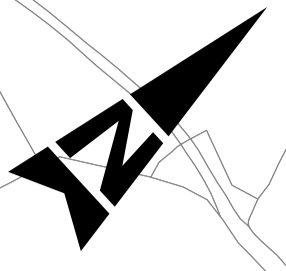

This map is reproduced from Ordnance Survey material with the permission of Ordnance Survey on behalf of the controller of Her Majesty's Stationery Office. © Crown Copyright. Unauthorised reproduction infringes Crown copyright and may lead to prosecution or civil proceedings. CLIENT NAME: Highways England LICENCE NUMBER: 100030649 (2018)

GENERAL NOTES:
 1. ALL DIMENSIONS ARE IN METRES UNLESS NOTED OTHERWISE.
 2. ONLY WRITTEN DIMENSIONS SHALL BE USED, DO NOT SCALE.
 3. THESE PLANS SHOULD BE READ IN CONJUNCTION WITH OTHER PLANS AND APPLICATION DOCUMENTS IN PARTICULAR SCHEDULE 3 OF THE DEVELOPMENT CONSENT ORDER.

LEGEND:
 - - - - - DEVELOPMENT CONSENT ORDER BOUNDARY
 - - - - - A30 MAINLINE CENTRELINE
 - - - - - EXTENT OF CARRIAGEWAY (INCLUDING 0.5M LATERAL DEVIATION)
 - - - - - A30 MAINLINE EARTHWORKS (INCLUDING 1.75M LATERAL DEVIATION)
 - - - - - SIDE ROAD, JUNCTION AND SLIP ROAD CENTRELINE
 - - - - - SIDE ROAD EARTHWORKS (INCLUDING 1.75M LATERAL DEVIATION)
 - - - - - UTILITY DIVERSION WORK CENTRELINE
 - - - - - ATTENUATION POND BOUNDARY
 - - - - - PARISH BOUNDARY

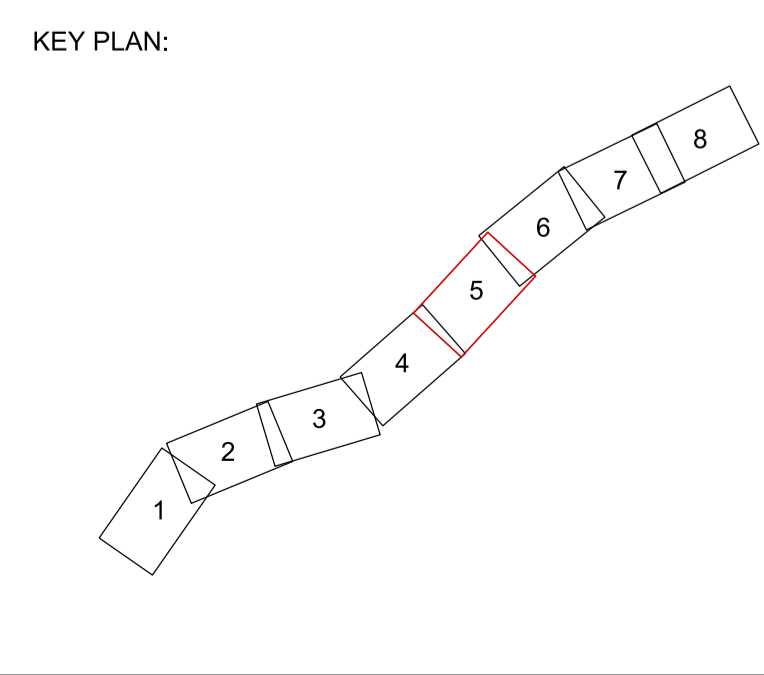
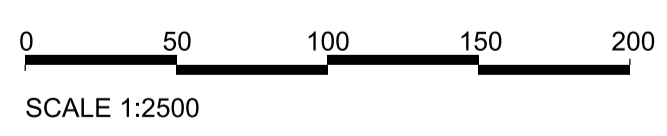

Rev.	Date	Description	By	Chk'd	App'd	Auth'd
P04	20/08/18	ISSUED FOR COMMENT	LP	LP	RC	RC
P05	04/07/18	ISSUED FOR COMMENT	ES	RC	RC	RC
P06	04/07/18	ISSUED FOR COMMENT	ES	RC	RC	RC
P07	02/08/18	FOR SIGN OFF	HJ	SW	DG	—
P08	02/08/18	FOR SIGN OFF	HJ	SW	DG	SW
P09	20/08/18	P09	HJ	LP	RC	—
P10	21/08/18	DCO ISSUE	HJ	LP	RC	—
P11	21/08/18	DCO ISSUE	HJ	LP	RC	RC
P12	22/08/18	DCO ISSUE	HJ	LP	RC	SW
C01	22/08/18	DCO ISSUE	HJ	LP	RC	SW

Suitability	A3	Drawing Status	STAGE COMPLETED
Client			

Project Title						A30 CHIVERTON TO CARLAND CROSS					
Drawing Title						WORKS PLANS APFP REGULATION 5(2)(J) SHEET 5 OF 8					
Scale	1:2500	By	HJ	Checked	LP	Approved	RC	Authorised	SW		
Original Size	A1	Date	21/08/18	Date	21/08/18	Date	21/08/18	Date	22/08/18		
Drawing Number	HA551502 - SW	Originator	ARP	Volume	LSI	-DR - ZL - 000405		C01			
Location		Type		Role		Number					

DO NOT SCALE

100
0 10
Millimetres

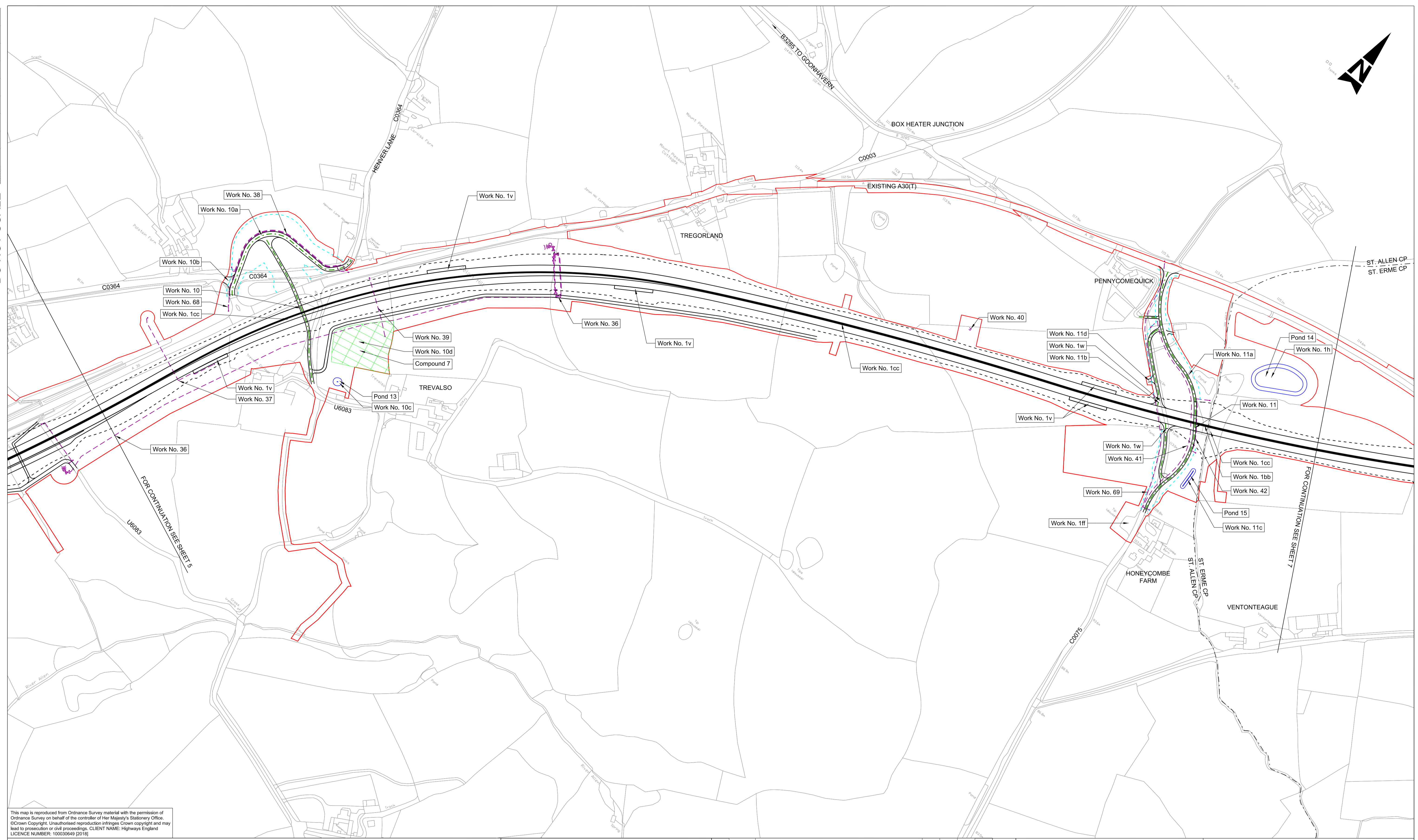

This map is reproduced from Ordnance Survey material with the permission of Ordnance Survey on behalf of the controller of Her Majesty's Stationery Office. © Crown Copyright. Unauthorised reproduction infringes Crown copyright and may lead to prosecution or civil proceedings. CLIENT NAME: Highways England LICENCE NUMBER: 100030649 (2018)

GENERAL NOTES:
 1. ALL DIMENSIONS ARE IN METRES UNLESS NOTED OTHERWISE.
 2. ONLY WRITTEN DIMENSIONS SHALL BE USED, DO NOT SCALE.
 3. THESE PLANS SHOULD BE READ IN CONJUNCTION WITH OTHER PLANS AND APPLICATION DOCUMENTS IN PARTICULAR SCHEDULE 3 OF THE DEVELOPMENT CONSENT ORDER

- LEGEND:**
- DEVELOPMENT CONSENT ORDER BOUNDARY
 - A30 MAINLINE CENTRELINE
 - EXTENT OF CARRIAGEWAY (INCLUDING 0.5M LATERAL DEVIATION)
 - A30 MAINLINE EARTHWORKS (INCLUDING 1.75M LATERAL DEVIATION)
 - SIDE ROAD, JUNCTION AND SLIP ROAD CENTRELINE
 - SIDE ROAD EARTHWORKS (INCLUDING 1.75M LATERAL DEVIATION)
 - UTILITY DIVERSION WORK CENTRELINE
 - ATTENUATION POND BOUNDARY
 - PARISH BOUNDARY

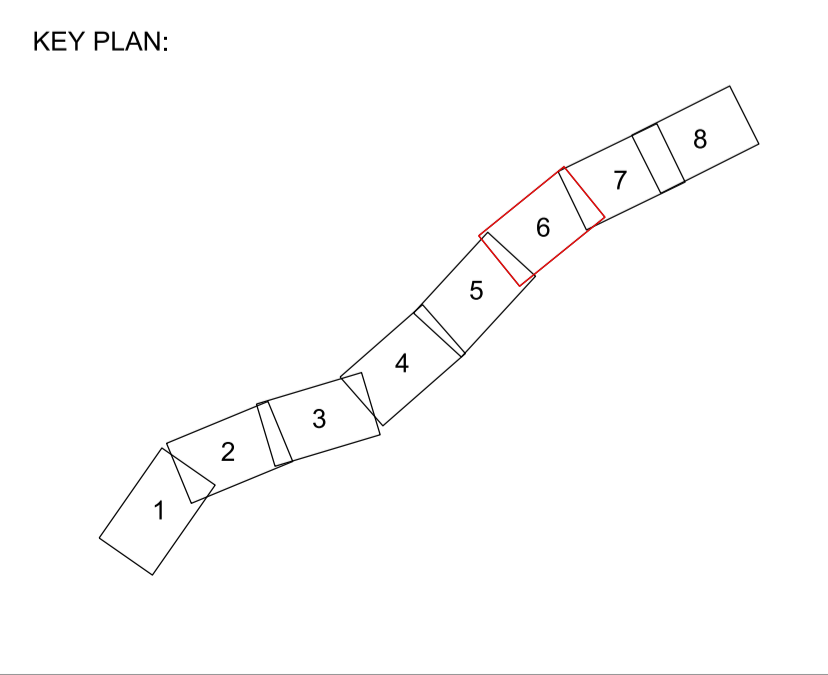
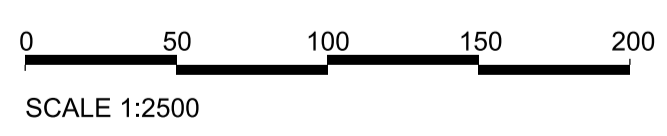

Rev.	Date	Description	By	Chk'd	App'd	Auth'd
P04	20/08/18	ISSUED FOR COMMENT	LP	LP	RC	RC
P05	04/07/18	ISSUED FOR COMMENT	ES	RC	RC	—
P06	04/07/18	ISSUED FOR COMMENT	ES	RC	RC	RC
P07	02/08/18	FOR SIGN OFF	HJ	SW	DG	—
P08	02/08/18	FOR SIGN OFF	HJ	SW	DG	SW
P09	20/08/18	P09	HJ	LP	RC	—
P10	21/08/18	DCO ISSUE	HJ	LP	RC	—
P11	21/08/18	DCO ISSUE	HJ	LP	RC	RC
P12	22/08/18	DCO ISSUE	HJ	LP	RC	SW
C01	22/08/18	DCO ISSUE	HJ	LP	RC	SW

Suitability	Drawing Status
A3	STAGE COMPLETED



Project Title A30 CHIVERTON TO CARLAND CROSS					
Drawing Title WORKS PLANS APFP REGULATION 5(2)(J) SHEET 6 OF 8					
Scale	By	Checked	Approved	Authorised	
1:2500	HJ	LP	RC	SW	
Original Size	Date	Date	Date	Date	Date
A1	21/08/18	21/08/18	21/08/18	22/08/18	22/08/18
Drawing Number	HE PIN	Originator	Volume	Revision	
HA551502 - SW	ARP	-DR - ZL	LSI -000406	C01	
Location	Type	Role	Number		

DO NOT SCALE

Millimetres

0 10 100

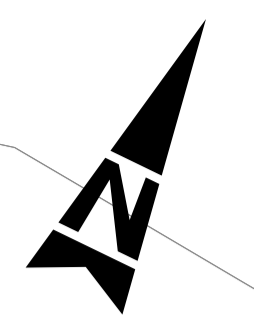
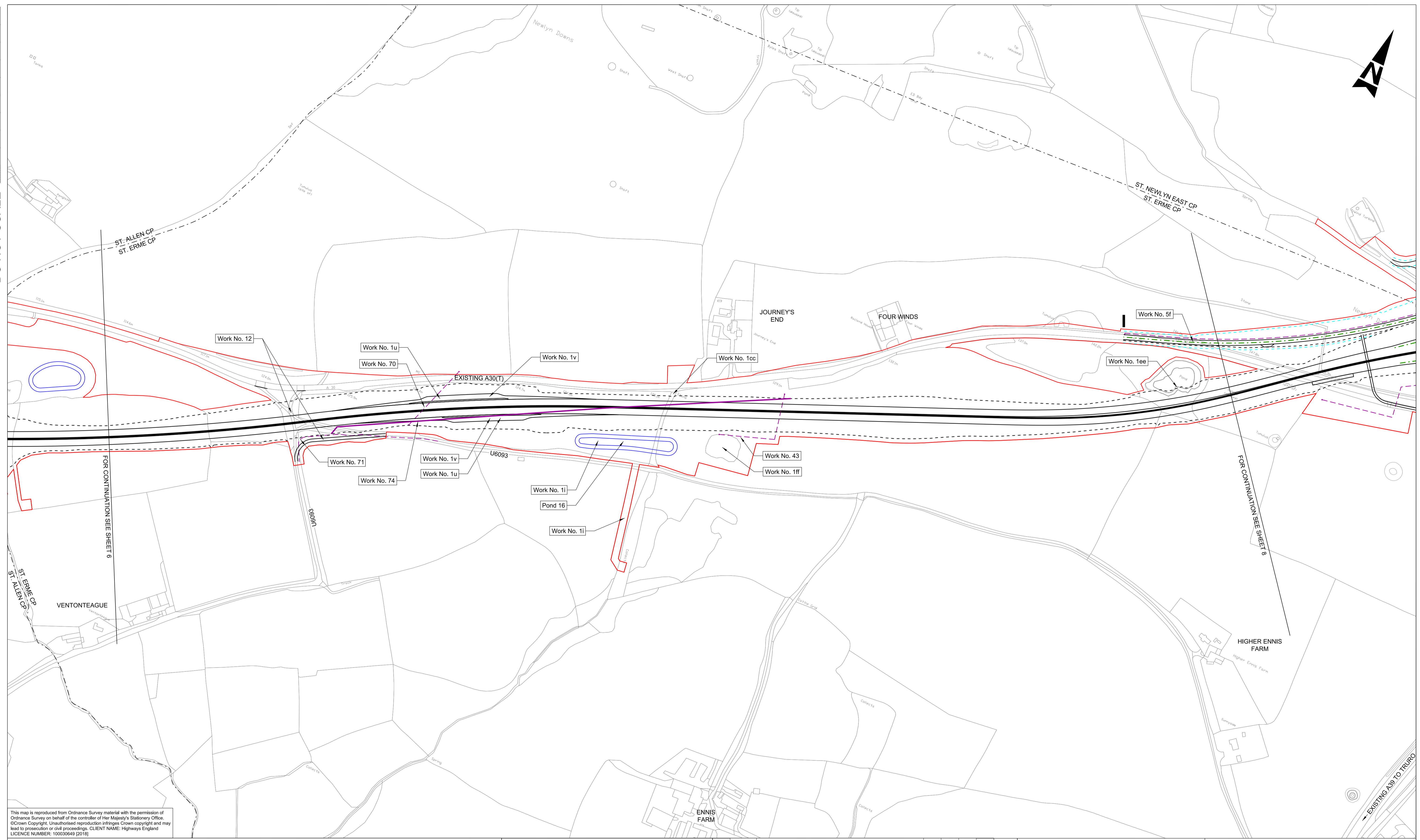

This map is reproduced from Ordnance Survey material with the permission of Ordnance Survey on behalf of the controller of Her Majesty's Stationery Office. © Crown Copyright. Unauthorised reproduction infringes Crown copyright and may lead to prosecution or civil proceedings. CLIENT NAME: Highways England LICENCE NUMBER: 100030649 (2018)

- GENERAL NOTES:**
- ALL DIMENSIONS ARE IN METRES UNLESS NOTED OTHERWISE.
 - ONLY WRITTEN DIMENSIONS SHALL BE USED, DO NOT SCALE.
 - THESE PLANS SHOULD BE READ IN CONJUNCTION WITH OTHER PLANS AND APPLICATION DOCUMENTS IN PARTICULAR SCHEDULE 3 OF THE DEVELOPMENT CONSENT ORDER.
- LEGEND:**
- DEVELOPMENT CONSENT ORDER BOUNDARY
 - A30 MAINLINE CENTRELINE
 - EXTENT OF CARRIAGEWAY (INCLUDING 0.5M LATERAL DEVIATION)
 - A30 MAINLINE EARTHWORKS (INCLUDING 1.75M LATERAL DEVIATION)
 - SIDE ROAD, JUNCTION AND SLIP ROAD CENTRELINE
 - SIDE ROAD EARTHWORKS (INCLUDING 1.75M LATERAL DEVIATION)
 - UTILITY DIVERSION WORK CENTRELINE
 - ATTENUATION POND BOUNDARY
 - PARISH BOUNDARY
 - DEMOLISHED OIL PIPE LINE

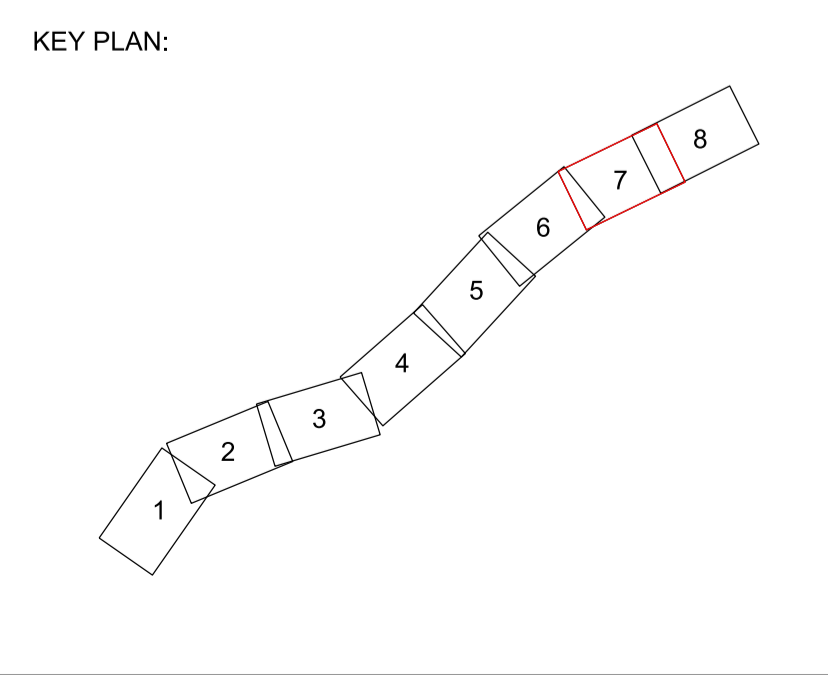
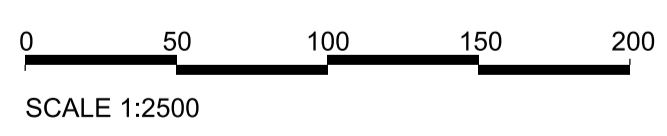

Rev.	Date	Description	By	Chk'd	App'd	Auth'd
P04	20/08/18	ISSUED FOR COMMENT	LP	LP	RC	RC
P05	04/07/18	ISSUED FOR COMMENT	ES	RC	RC	—
P06	04/07/18	ISSUED FOR COMMENT	ES	RC	RC	RC
P07	02/08/18	FOR SIGN OFF	HJ	SW	DG	—
P08	02/08/18	FOR SIGN OFF	HJ	SW	DG	SW
P09	20/08/18	P09	HJ	LP	RC	—
P10	21/08/18	DCO ISSUE	HJ	LP	RC	—
P11	21/08/18	DCO ISSUE	HJ	LP	RC	RC
P12	22/08/18	DCO ISSUE	HJ	LP	RC	SW
C01	22/08/18	DCO ISSUE	HJ	LP	RC	SW

Suitability A3 **Drawing Status** STAGE COMPLETED

Client

Project Title A30 CHIVERTON TO CARLAND CROSS					
Drawing Title WORKS PLANS APFP REGULATION 5(2)(J) SHEET 7 OF 8					
Scale	1:2500	By	HJ	Checked	LP
Original Size	A1	Date	21/08/18	Approved	RC
Drawing Number	HA551502 - SW	Originator	ARP	Volume	LSI
Location	SW	Type	-DR	Role	ZL
Number		Number	-000407	Revision	C01

DO NOT SCALE

Millimetres

0 10

100

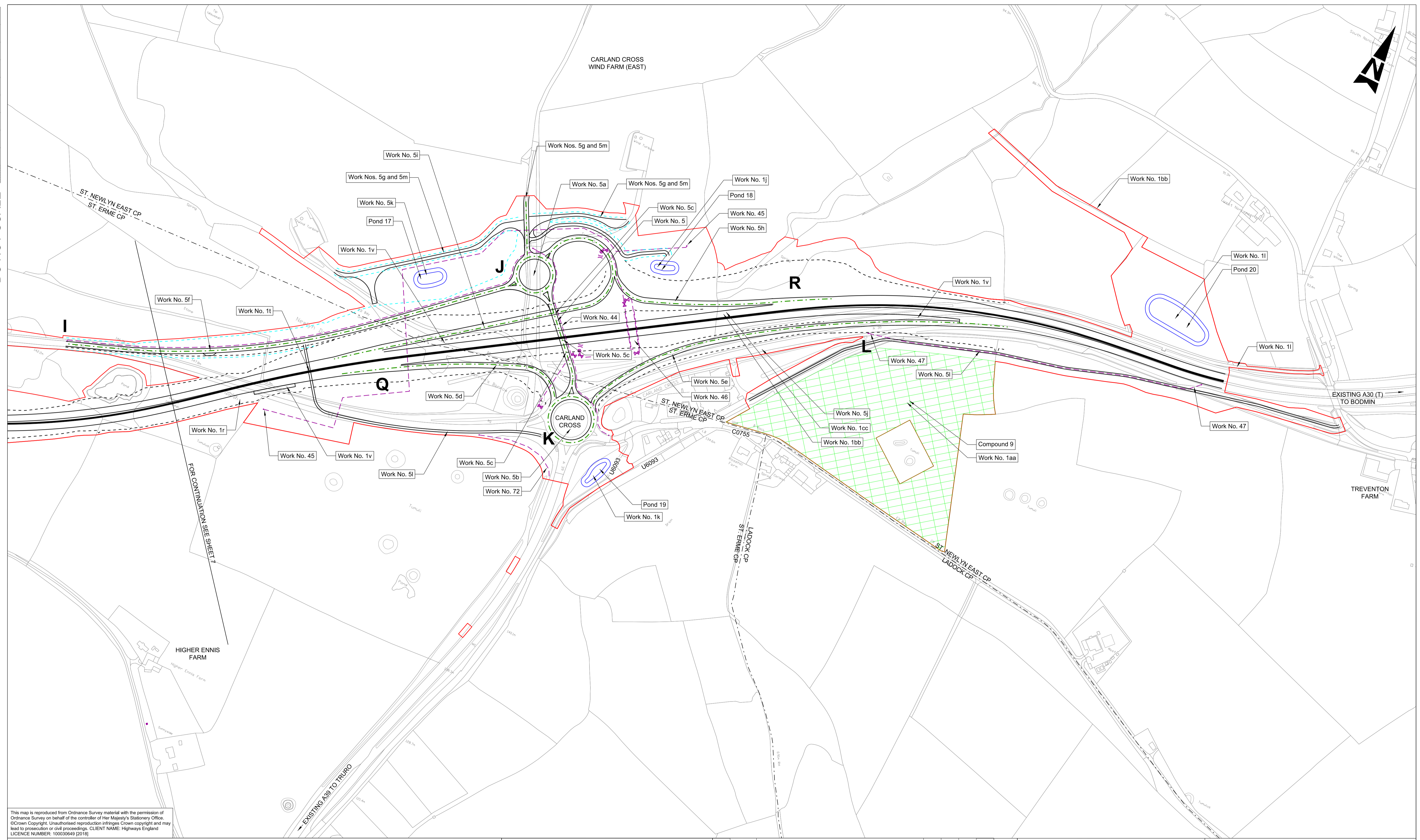

If you need help accessing this or any other Highways England information, please call **0300 123 5000** and we will help you.